

**ABERNATHY and ASSOCIATES**

**Kenneth B. Abernathy Jr.**

**Wisconsin Registered Land Surveyor S-1594**

Rt. 3, Box 273  
Elkhorn, Wisconsin 53121  
Phone: (414) 723-4260 (office)  
(414) 723-4813 (residence)

**PLAT OF SURVEY**

LOT 18 OF PINE KNOLLS  
SUBDIVISION, LOCATED IN THE  
NORTHEAST 1/4 OF THE NORTHEAST  
1/4 OF SECTION 34, TOWN 4 NORTH,  
RANGE 15 EAST, TOWN OF  
WHITEWATER, WALWORTH COUNTY,  
WISCONSIN.

OWNERS: RANDY AND LAURIE HARNICK  
2704 ROSEVELT AVE.  
JANESVILLE, WI. 53546

BUILDER: FILTER CONSTRUCTION  
W4969 HAWK RD.  
ELKHORN, WI. 53121

LOT 19

**LOT 18**  
1.03 ACRES

**PINE KNOLLS DRIVE**

66' WIDE

N 89°51'00" E 200.00'

UTILITY PEDESTAL

**RESIDENCE  
UNDER  
CONSTRUCTION**

LOT 17

SCALE: 1" = 40 FEET

Legend

- FOUND IRON PIPE
- FOUND IRON ROD
- FOUND BRASS CAPPED MONUMENT
- FOUND CONCRETE MONUMENT
- CHISEL CUT IN CONCRETE
- SET IRON ROD, 24" LONG, WEIGHING  
1.5 LBS./LINEAL FT., 3/4" DIA.
- SET IRON ROD, 30" LONG, WEIGHING  
4.5 LBS./LINEAL FT., 1-11/16" DIA.
- (xx) RECORDED AS DIMENSION
- x-x- EXISTING FENCE

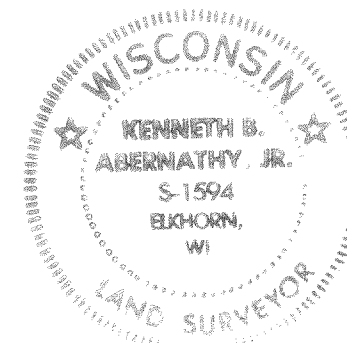

"I hereby certify that I have surveyed the above described property and that the above map is a true representation thereof and shows the size and location of the property, its exterior boundaries, the location of all visible structures and dimensions of all principal buildings thereon, boundary fences, apparent easements, roadways and visible encroachments, if any."

"This survey is made for the use of the present owners of the property, and also those who purchase, mortgage, or guarantee the title thereto within one year from date hereof."

*Kenneth B. Abernathy, Jr.*

**KENNETH B. ABERNATHY, JR.**  
**WISCONSIN REGISTERED LAND SURVEYOR,**  
**S-1594**

Date: JUNE 16, 1998 Job No. 98-609

REVISED JUNE 25, 1998  
REVISED SEPTEMBER 16, 1998

415-671  
DPK-18

**ABERNATHY and ASSOCIATES**

**Kenneth B. Abernathy Jr.**

**Wisconsin Registered Land Surveyor S-1594**

Rt. 3, Box 273  
Elkhorn, Wisconsin 53121  
Phone: (414) 723-4260 (office)  
(414) 723-4813 (residence)

## PLAT OF SURVEY

LOT 18 OF PINE KNOLLS  
SUBDIVISION, LOCATED IN THE  
NORTHEAST 1/4 OF THE NORTHEAST  
1/4 OF SECTION 34, TOWN 4 NORTH,  
RANGE 15 EAST, TOWN OF  
WHITEWATER, WALWORTH COUNTY,  
WISCONSIN.

OWNERS: RANDY AND LAURIE HARNICK  
2704 ROSEVELT AVE.  
JANESVILLE, WI. 53546

BUILDER: FILTER CONSTRUCTION  
W4969 HAWK RD.  
ELKHORN, WI. 53121

LOT 19

PROPOSED RESIDENCE

**LOT 18**  
1.03 ACRES

NOTE  
WOOD STAKES HAVE BEEN PLACED AT BUILDING CORNERS.  
BUILDER IS TO VERIFY DIMENSIONS WHICH HAVE BEEN  
ROUNDED TO THE NEAREST TENTH OF A FOOT TO INSURE  
PROPER PLAN INTERPRETATION AND CONTACT THIS OFFICE  
IMMEDIATELY IF ANY DISCREPANCY EXISTS.  
SEE BUILDERS PLANS FOR ADDITIONAL INFORMATION.

PINE KNOLLS DRIVE  
66' WIDE

N 89°51'00" E 200.00'

UTILITY PEDESTAL

N 0°09'00" W 225.00'

S 0°09'00" E 225.00'

LOT 17

10' wide utility easement

S 89°51'00" W 200.00'

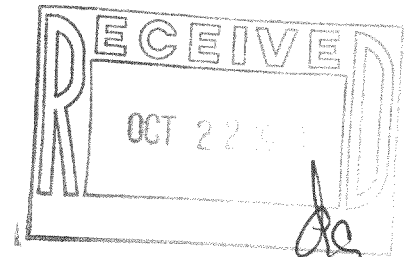

SCALE: 1" = 40 FEET

### Legend

- FOUND IRON PIPE
- FOUND IRON ROD
- FOUND BRASS CAPPED MONUMENT
- ⊗ FOUND CONCRETE MONUMENT
- + CHISEL CUT IN CONCRETE
- SET IRON ROD, 24" LONG, WEIGHING 1.5 LBS./LINEAL FT., 3/4" DIA.
- SET IRON ROD, 30" LONG, WEIGHING 4.5 LBS./LINEAL FT., 1-11/16" DIA.
- (xx) RECORDED AS DIMENSION
- x-x- EXISTING FENCE

"I hereby certify that I have surveyed the above described property and that the above map is a true representation thereof and shows the size and location of the property, its exterior boundaries, the location of all visible structures and dimensions of all principal buildings thereon, boundary fences, apparent easements, roadways and visible encroachments, if any."

"This survey is made for the use of the present owners of the property, and also those who purchase, mortgage, or guarantee the title thereto within one year from date hereof."

*Kenneth B. Abernathy Jr.*

KENNETH B. ABERNATHY, JR.  
WISCONSIN REGISTERED LAND SURVEYOR,  
S-1594

Date: JUNE 16, 1998 Job No. 98.609

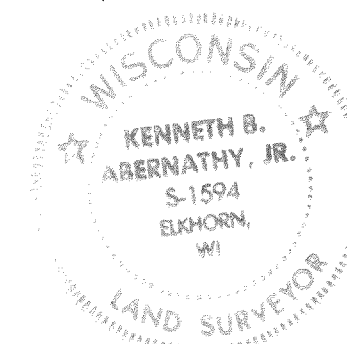

**ABERNATHY and ASSOCIATES**

**Kenneth B. Abernathy Jr.**

**Wisconsin Registered Land Surveyor S-1594**

Rt. 3, Box 273  
Elkhorn, Wisconsin 53121  
Phone: (414) 723-4260 (office)  
(414) 723-4813 (residence)

**PLAT OF SURVEY**

**PINE KNOLLS DRIVE**

66' WIDE

LOT 18 OF PINE KNOLLS  
SUBDIVISION, LOCATED IN THE  
NORTHEAST 1/4 OF THE NORTHEAST  
1/4 OF SECTION 34, TOWN 4 NORTH,  
RANGE 15 EAST, TOWN OF  
WHITEWATER, WALWORTH COUNTY,  
WISCONSIN.

OWNERS: RANDY AND LAURIE HARNICK  
2704 ROSEVELT AVE.  
JANESVILLE, WI. 53546

BUILDER: FILTER CONSTRUCTION  
W4969 HAWK RD.  
ELKHORN, WI. 53121

LOT 19

N 0°09'00" W 225.00'

**LOT 18**  
1.03 ACRES

N 89°51'00" E 200.00'

UTILITY PEDESTAL

**PROPOSED  
RESIDENCE**

S 0°09'00" E 225.00'

LOT 17

10' wide utility easement

S 89°51'00" W 200.00'

NOTE  
WOOD STAKES HAVE BEEN PLACED AT BUILDING CORNERS.  
BUILDER IS TO VERIFY DIMENSIONS WHICH HAVE BEEN  
ROUNDED TO THE NEAREST TENTH OF A FOOT TO INSURE  
PROPER PLAN INTERPRETATION AND CONTACT THIS OFFICE  
IMMEDIATELY IF ANY DISCREPANCY EXISTS.  
SEE BUILDERS PLANS FOR ADDITIONAL INFORMATION.

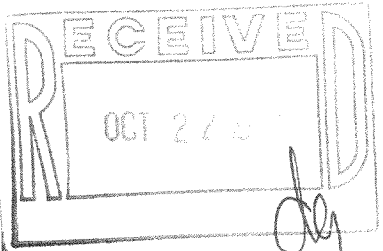

SCALE: 1"=40 FEET

**Legend**

- FOUND IRON PIPE
- FOUND IRON ROD
- FOUND BRASS CAPPED MONUMENT
- FOUND CONCRETE MONUMENT
- CHISEL CUT IN CONCRETE
- SET IRON ROD, 24" LONG, WEIGHING 1.5 LBS./LINEAL FT., 3/4" DIA.
- SET IRON ROD, 30" LONG, WEIGHING 4.5 LBS./LINEAL FT., 1-11/16" DIA.
- (xx) RECORDED AS DIMENSION
- x-x- EXISTING FENCE



"I hereby certify that I have surveyed the above described property and that the above map is a true representation thereof and shows the size and location of the property, its exterior boundaries, the location of all visible structures and dimensions of all principal buildings thereon, boundary fences, apparent easements, roadways and visible encroachments, if any."  
"This survey is made for the use of the present owners of the property, and also those who purchase, mortgage, or guarantee the title thereto within one year from date hereof."

*Kenneth B. Abernathy, Jr.*

**KENNETH B. ABERNATHY, JR.**  
**WISCONSIN REGISTERED LAND SURVEYOR,**  
**S-1594**

REVISED JUNE 25, 1998

Date: JUNE 16, 1998 Job No. 98609